

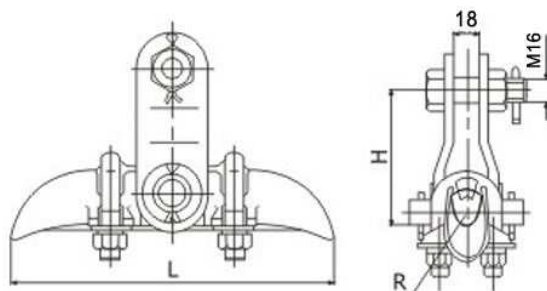

SUSPENSION CLAMP

Suspension clamps are used to hang conductors or ground wires to insulators or link fittings to tower arms and substation structures. WINNING® suspension clamps are made of Aluminum Alloy or Malleable Iron materials with various types. Custom size and requirements are available upon request.

1. XGU Suspension Clamp (Trunnion Type)



Catalog No.	Applicable Conductor Diameter (mm)	Main Dimensions (mm)			Rated Failure Load (kN)	Weight (kg)
		H	L	R		
XGU-1	5.00~7.00	82	180	4.0	40	1.4
XGU-2	7.10~13.0	82	200	7.0	40	1.8
XGU-3	13.1~21.0	102	220	11.0	40	2.0
XGU-4	21.1~26.0	110	250	13.5	40	3.0
XGU-5	23.0~33.0	87	300	17.0	60	4.7
XGU-6	34.0~45.0	93	300	23.0	60	5.1

The clamp body and keeper are made of malleable iron, cotter pins are stainless steel, and other parts are steel. All ferrous parts are Hot Dip Galvanized.

2. XGU Suspension Clamp (With Socket-Clevis Eye)

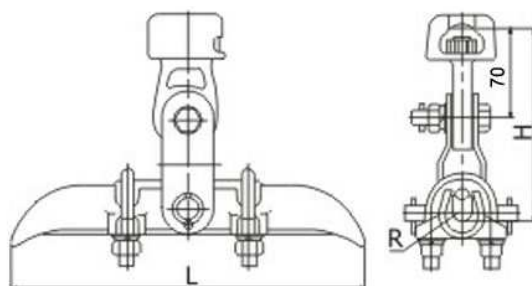

Catalog No.	Applicable Conductor Diameter (mm)	Main Dimensions (mm)			Rated Failure Load (kN)	Weight (kg)
		H	L	R		
XGU-5A	23.0~33.0	157	300	17	70	5.7
XGU-6A	34.0~45.0	163	300	23	70	6.1

The clamp body and keeper are made of malleable iron, cotter pins are stainless steel, and other parts are steel. All ferrous parts are Hot Dip Galvanized.



3. XGU Suspension Clamp (With U-Type Clevis)

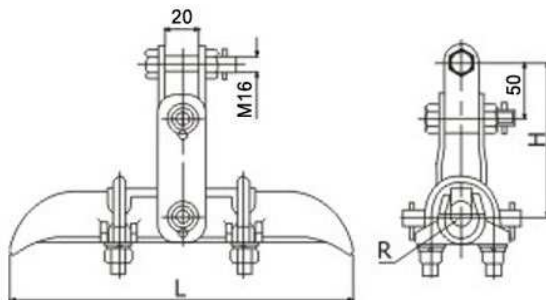

Catalog No.	Applicable Conductor Diameter (mm)	Main Dimensions (mm)			Rated Failure Load (kN)	Weight (kg)
		H	L	R		
XGU-5B	23.0~33.0	137	300	17	70	5.4
XGU-6B	34.0~45.0	143	300	23	70	5.8
XGU-7B	45.0~48.7	156	300	26	70	6.2

The clamp body and keeper are made of malleable iron, cotter pins are stainless steel, and other parts are steel. All ferrous parts are Hot Dip Galvanized.

4. XGU Suspension Clamp (Abrasion-Proof Type)

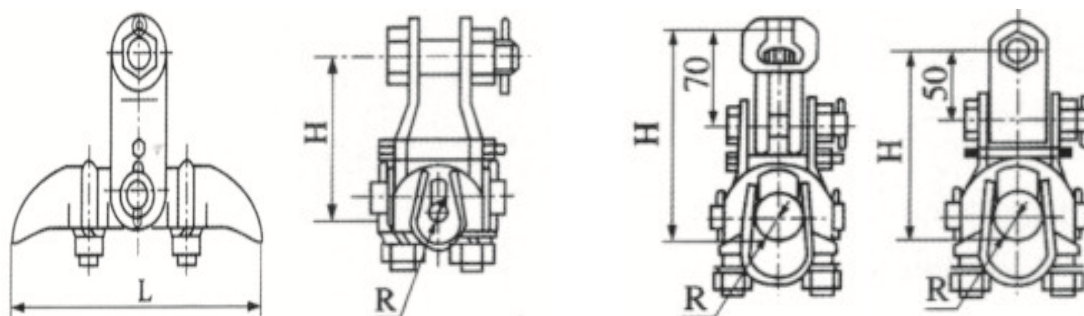

Catalog No.	Applicable Conductor Diameter (mm)	Main Dimensions (mm)			Rated Failure Load (kN)	Weight (kg)
		H	L	R		
XGU-1F	5.0~7.0	82	180	4.0	40	1.4
XGU-2F	7.1~13.0	102	200	7.0	40	1.8
XGU-3F	13.1~21.0	121	220	11.0	40	2.0
XGU-4F	21.1~26.0	130	250	13.5	40	3.0
XGU-5F	23.0~33.0	140	300	17	60	4.7
XGU-6F	34.0~45.0	155	300	23	60	5.1
XGU-5AF	23.0~33.0	210	300	17	60	5.7
XGU-6AF	34.0~45.0	220	300	23	60	6.1
XGU-5BF	23.0~33.0	190	300	17	60	5.4
XGU-6BF	34.0~45.0	205	300	23	60	5.8
XGU-7BF	45.0~48.7	310	300	26	60	6.4

The clamp body and keeper are made of malleable iron, cotter pins are stainless steel, and other parts are steel. All ferrous parts are Hot Dip Galvanized.



5. XGF (CGF) Aluminum Alloy Suspension Clamp (Hand-down Type)

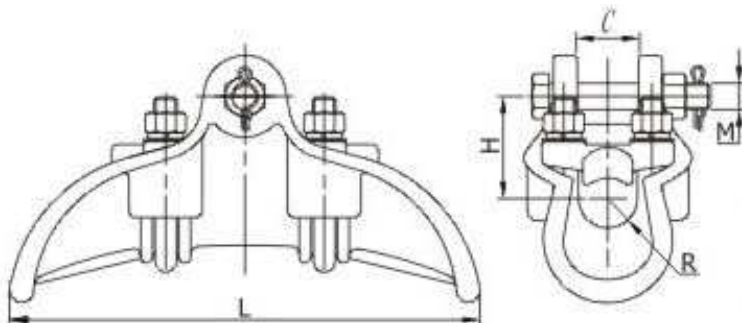

Catalog No.	Applicable Conductor Diameter (mm)	Main Dimensions (mm)					Rated Failure Load (kN)	Weight (kg)
		H	L	R	C	M		
XGF-4	20.0~26.0	60	280	13	28	16	70	2.37
XGF-5	26.0~34.0	65	300	17	36	16	70	2.75
XGF-1040	34.0~40.0	70	320	20	42	18	100	3.46
XGF-6	40.0~46.0	73	320	23	48	18	100	3.52

The clamp body and keeper are made of Aluminum Alloy, cotter pins are stainless steel, and other parts are Hot Dip Galvanized steel.

6. XGF (CGF) Aluminum Alloy Suspension Clamp (Carried-up Type)

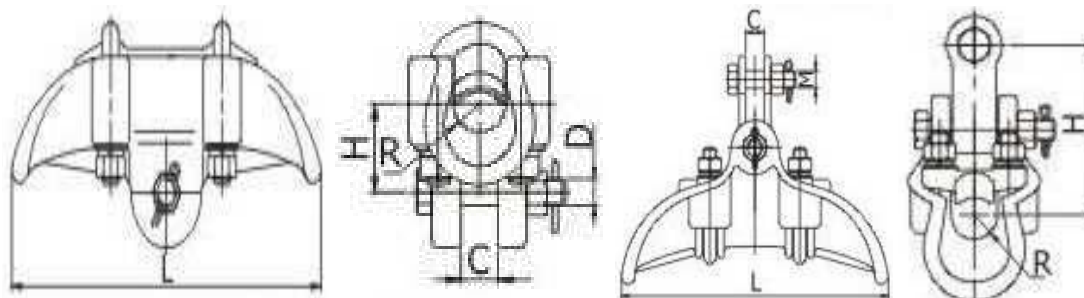

Catalog No.	Applicable Conductor Diameter (mm)	Main Dimensions (mm)					Rated Failure Load (kN)	Weight (kg)
		H	L	R	C	M		
XGF-5K	26.0~34.0	55	300	17	24	18	70	3.0
XGF-1040K	34.0~40.0	60	320	20	24	18	100	3.6
XGF-6K	40.0~46.0	63	320	23	26	18	70	6.6
Carried-up Type with U-Clevis (Figure Right)								
XGF-5C	26.2~34.0	130	300	17	20	16	70	3.3
XGF-1040C	34.0~40.0	140	320	20	22	18	100	4.1
XGF-6C	40.0~46.0	153	320	23	20	18	100	4.3
XGF-1054C	44.0~54.9	153	320	27	24	18	100	4.9
XGF-1054C	44.0~54.9	173	390	27	26	24	100	5.3

The clamp body and keeper are made of Aluminum Alloy, cotter pins are stainless steel, and other parts are Hot Dip Galvanized steel.



7. XGH Aluminum Alloy Suspension Clamp (Envelope Type)

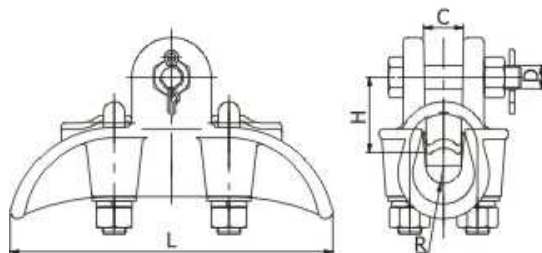

Catalog No.	Applicable Conductor Diameter (mm)	Main Dimensions (mm)				Rated Failure Load (kN)	Weight (kg)
		H	C	D	L		
XGH-2	5.0~12.5	52.5	25	16	166	40	1.0
XGH-3	12.4~17.0	50.5	23	16	200	40	1.5
XGH-3A	12.4~17.0	50.0	22	16	180	50	1.5
XGH-4	19.0~23.5	59.5	27	16	225	40	2.3
XGH-5	24.2~28.0	70.0	32	16	260	60	4.4
XGH-6	25.0~35.0	68	36.5	16	216	60	3.5
XGH-7	27.0~39.0	54	40.0	16	230	70	3.9
XGH-8	28.0~41.2	78	43.0	16	241	70	4.0
XGH-9	31.3~46.2	83	48.6	16	254	70	4.2
XGH-10	35.6~51.8	95	54	16	267	70	4.5
XGH-11	44.5~57.2	95	58.7	16	280	70	4.8

The clamp body and keeper are made of Aluminum Alloy, cotter pins are stainless steel, and other parts are Hot Dip Galvanized steel.

8. XGJ Suspension Clamp

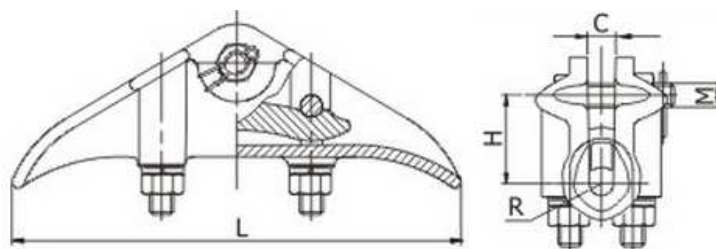

Catalog No.	Applicable Conductor Diameter (mm)	Main Dimensions (mm)				Rated Failure Load (kN)	Weight (kg)
		H	L	R	C		
XGJ-2	11.0~13.0	75	300	7.0	18	40	4.9
XGJ-3	13.1~18.0	75	300	11	27	40	5.6
XGJ-4	21.1~23.0	75	300	12	27	40	6.5
XGJ-5	23.0~43.0	80	390	18	38	70	8.7
XGJ-5A	34.0~45.0	90	476	23	48	90	9.8
XGJ-5B	34.0~45.0	90	476	23	48	90	9.8

The clamp body, keeper and socket-clevis are made of malleable iron; the closed-pin is stainless steel, and other parts are steel. All ferrous parts are Hot Dip Galvanized.



9. XGT (CGT) Suspension Clamp for Twin Conductors

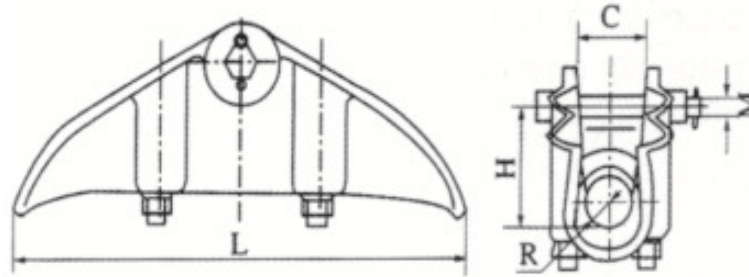

Catalog No.	Applicable Conductor Diameter (mm)	Main Dimensions (mm)					Rated Failure Load (kN)	Weight (kg)
		H	C	D/M	R	L		
XGT-1	5.0~7.0	60	18	18	4.0	180	40	3.3
XGT-2	7.1~13.0	75	18	18	7.0	200	40	4.9
XGT-3	13.1~21.0	75	27	16	11.0	220	40	5.6
XGT-4	21.1~26.0	62	27	16	13.5	250	60	6.5
XGT-5	23.0~26.0	81	38	16	17.0	300	60	8.7
XGT-6	34.0~45.0	89	46	16	23.0	300	60	9.8

The clamp body and keeper are made of Aluminum Alloy, cotter pins are stainless steel, and other parts are Hot Dip Galvanized steel.

10. CTS (XTS) Suspension Clamp for Twin Jumper Conductors

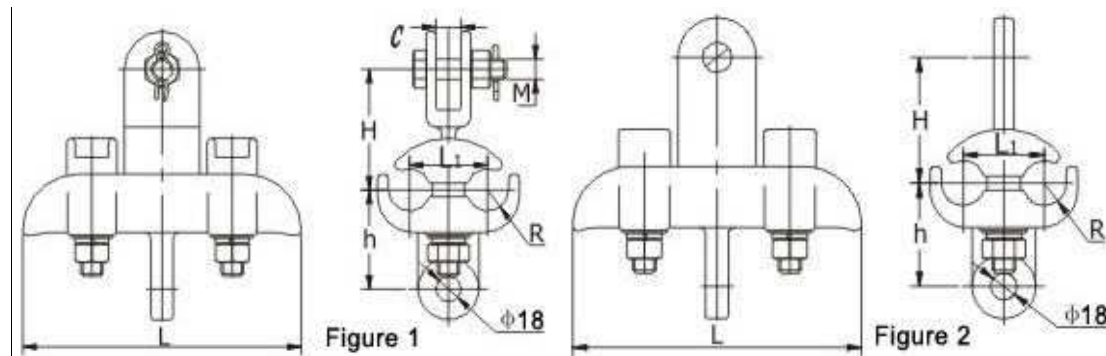

Catalog No.	Applicable Conductor Diameter (mm)	Main Dimensions (mm)						Rated Failure Load (kN)	Weight (kg)
		D	L1	L2	M	C	H		
XTS-1	18.0~24.0	26	200	50	16	19	57	40	4.5
XTS-2	25.0~31.0	32	200	56	16	19	62	40	5.0
XTS-2A	17.0~21.0	22	200	20	16	19	57	40	4.5
XTS-2B	21.0~27.0	28	200	52	16	19	59	40	5.0
XTS-5	23.0~33.0	34	200	60	18	20	55	100	4.2
XTS-6	34.0~50.0	46	250	77	16	20	70	70	7.5

The clamp body and keeper are made of Aluminum Alloy, cotter pins are stainless steel, and other parts are Hot Dip Galvanized steel.

CTS suspension clamp is a good replacement for XYS ones to increase life span.



11. CS Aluminum Alloy Suspension Clamp for Twin Jumper Conductor

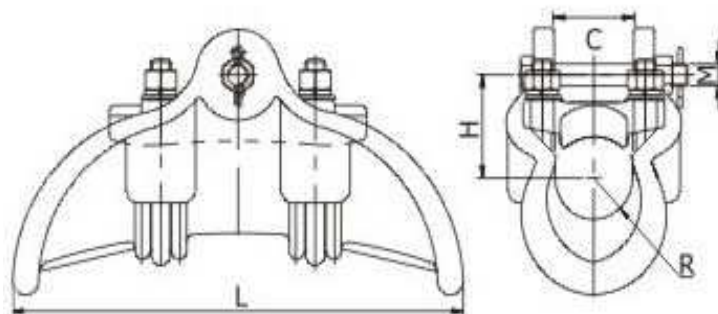

Catalog No.	Applicable Conductor Diameter (mm)	Main Dimensions (mm)					Rated Failure Load (kN)	Weight (kg)
		L	H	R	C	M		
CS-51	40.0~54.0	350	73	27	56	18	70	5.6
CS-52	53.0~66.0	350	75	30	62	20	70	6.2

The clamp body and keeper are made of Aluminum Alloy; cotter pins are stainless steel, and the other parts are Hot Dip Galvanized Steel.

12. XCS (CCS) Aluminum Alloy Suspension Clamp for Twin Conductors

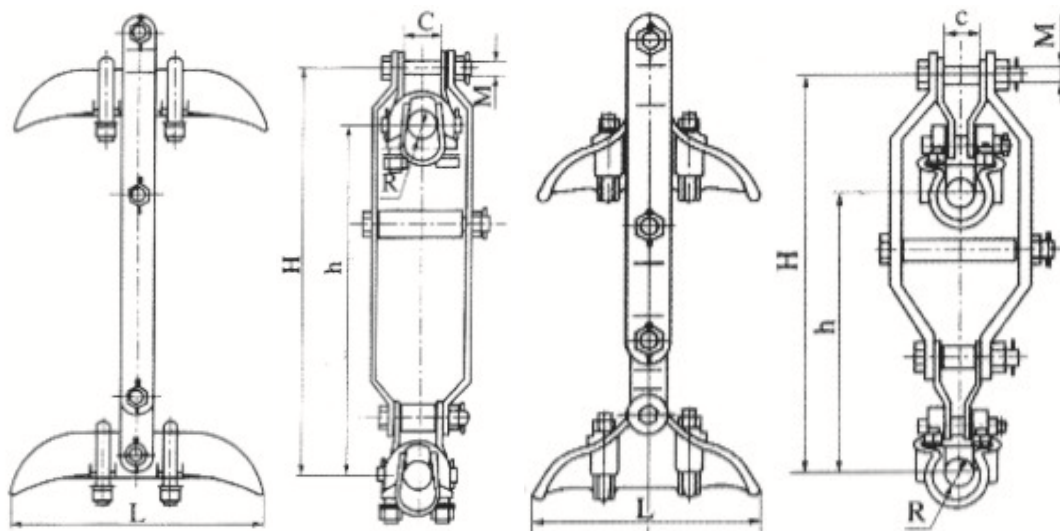

Catalog No.	Applicable Conductor Diameter (mm)	Main Dimensions (mm)						Rated Failure Load (kN)	Weight (kg)
		h	L	R	C	H	M		
XCS-4	21.0~26.0	400	250	13.5	20	490	18	70	9.3
XCS-5	23.0~33.0	400	300	17.0	38	490	18	100	10.8
XCS-6	34.0~45.0	400	300	23.0	38	495	18	100	12.5
XCS-4H	21.0~26.0	400	250	13.5	42	530	16	70	10.2
XCS-5H	26.0~31.5	400	300	16.0	44	545	18	100	11.4
XCS-6H	32.0~43.0	400	300	22.0	50	550	22	120	12.9

The clamp body and keeper are made of Aluminum Alloy, cotter pins are stainless steel, and other parts are Hot Dip Galvanized steel.



13. XT Aluminum Alloy Suspension Clamp for Four Jumper Conductors

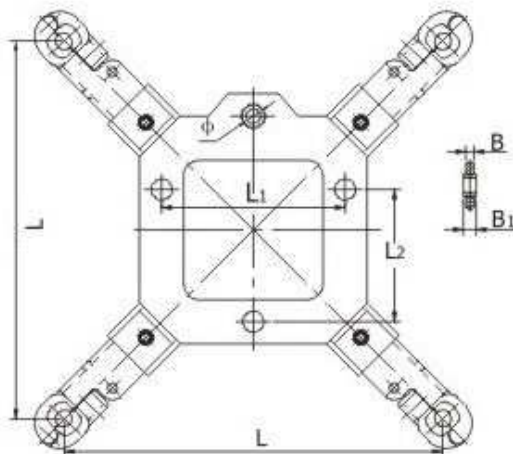

Catalog No.	Applicable Conductor Diameter (mm)	Main Dimensions (mm)						Weight (kg)
		B	B1	Φ	L1	L2	L	
XT4-45300	20.8~24.0	10	16	18	240	175	450	6.6
XT4-45400	24.0~28.0	10	16	18	240	175	450	6.6
XTF4-45300	20.8~24.0	10	16	18	240	165	450	8.6
XTF4-45400	24.0~28.0	10	16	18	240	165	450	8.6

The clamp body and keeper are made of Aluminum Alloy, cotter pins are stainless steel, and other parts are Hot Dip Galvanized steel.

14. Top Clamp for Horizontal Line Post Insulators

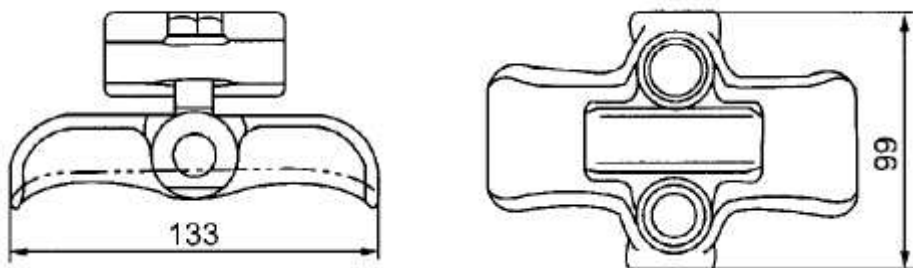

Catalog No.	Malleable Iron Material	XMR-1	XMR-2	XMR-3	XMR-4
	Aluminum Alloy Material	XAA-1	XAA-2	XAA-3	XAA-4
Conductor Diameter (mm)	Minimum	6.35	8.89	12.7	25.4
	Maximum	14.2	21.3	26.9	38.1

The clamp is used as top clamp for horizontal mounting line post insulator, which is made of Aluminum Alloy materials (Malleable Iron material available upon request).

Note: Custom sizes or drawings with special requirements are available upon request.